

# Ultron

## Large Level Ride 60" Aluminum Platform



- 84" x 60" wedge aluminum platform
- Platform comes with screw style adjusting bolts, bushings and grease zerks at all pivot points
- Twin cylinders offer a wider arm stance for better load stability

**Designed Simplicity - Maximum Performance**

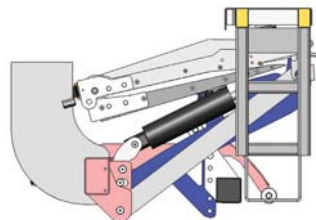

**DA Series**  
ULTRON'S DOCK ACCESS LIFT

# Designed Simplicity - Maximum Performance



**Steel Pump Box**

- Pre-assembled and mounted on gate
- Protects key components from damage



**Closed Cylinders**

- Protects cylinders from road abuse and surface rust
- Extends cylinder life



**Side Steps and Under Ride Bumper Standard**

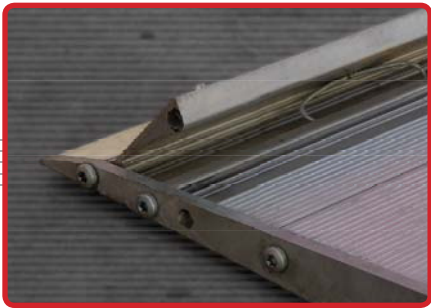
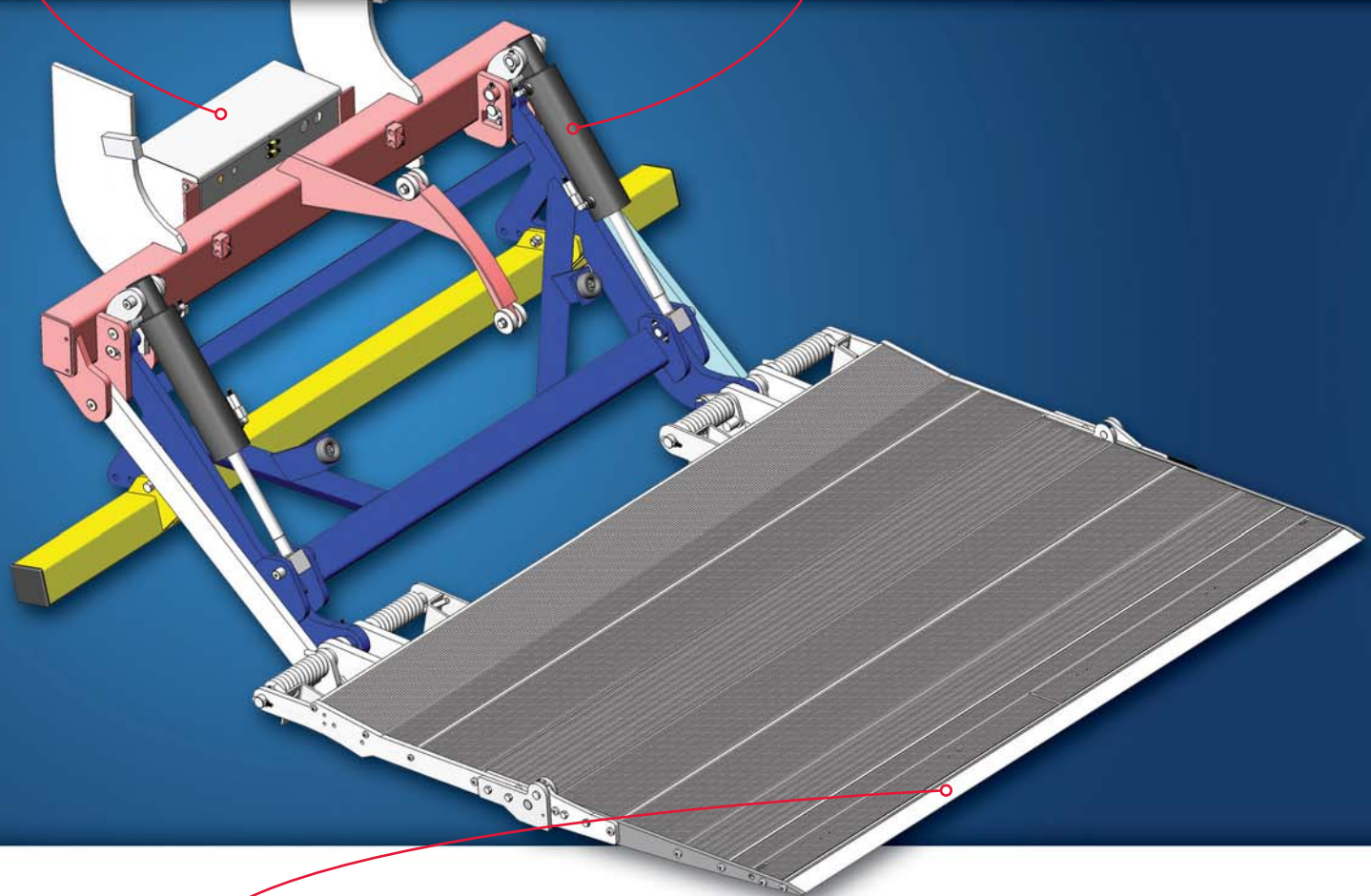

**Flip-Up Cart Stop**

- Optional Equipment
- Safe load retention
- Simple design and ease of use



**Safety Chain**

- Provides unintended lowering of gate



**Dock Extension**

- Standard 3/8"
- Optional 1/2" for extreme duty and heavy fork lift traffic

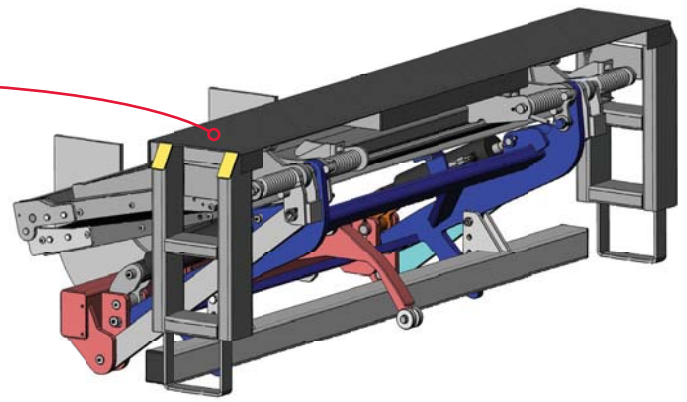

**DA Series**

ULTRON'S DOCK ACCESS LIFT

Dock Access 4000 lb Capacity Tuckaway Lift Gate

# Dock Access 4000 lb Capacity Tuckaway Product Information

## Clearance and Lift Dimensions

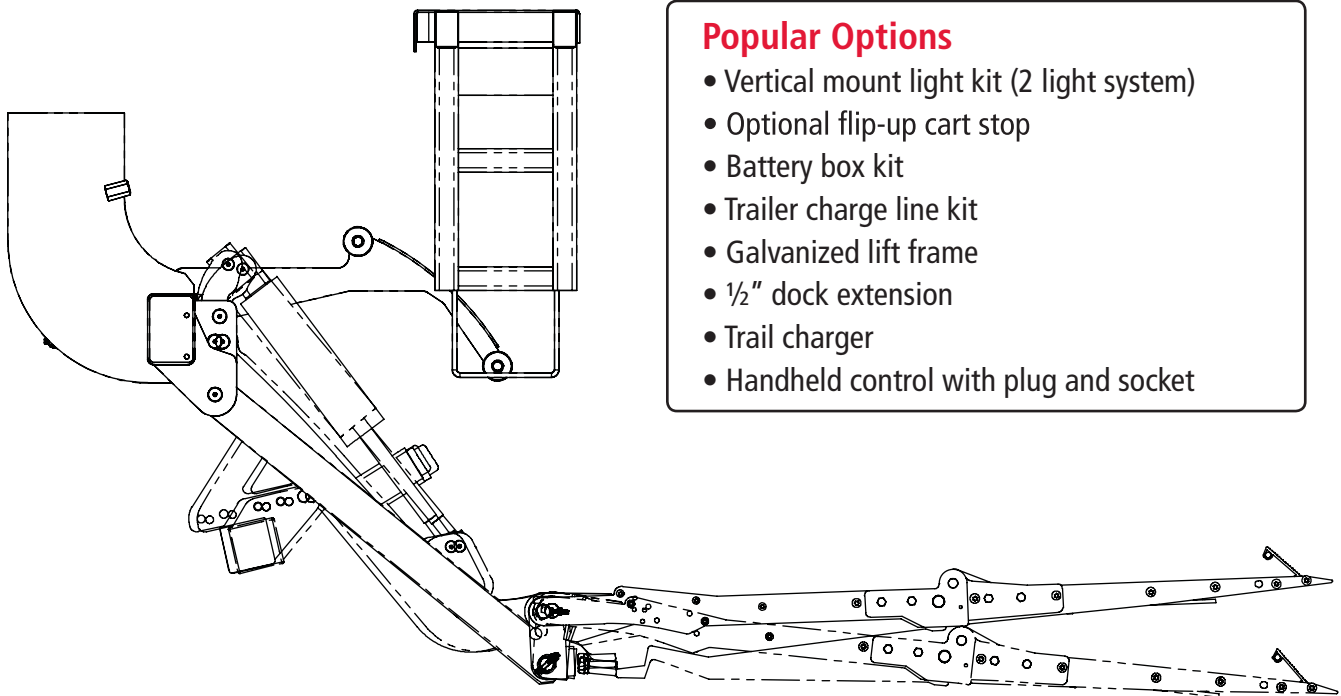

### Popular Options

- Vertical mount light kit (2 light system)
- Optional flip-up cart stop
- Battery box kit
- Trailer charge line kit
- Galvanized lift frame
- 1/2" dock extension
- Trail charger
- Handheld control with plug and socket

## Specifications

Model	Bed Height* Min-Max"	Capacity lbs.	Weight lbs.	Available Platform Sizes		Twin Cylinder
				width"	depth"	
DA408460TCWA	48-57	4,000	1,150	84	60	YES

\* Min. fully laden, max. unladen

## Standard Features

- Auto-levelling platform
- Heavy-duty aluminum extruded wedge style platform
- Maintenance free bushings with grease zerks at all critical points
- NitroBlack™ coated hinge pins for corrosion resistance and long life
- Steel pump box - sealed power unit box helps to eliminate common electrical problems
- Weather sealed electric controls are easier and safer than mechanical controls
- Standard power down
- Torsion assisted main and flip ramp for ease of opening and closing
- Under ride guard
- Heavy-duty side steps
- Reinforced heavy-duty 3/8" floor extension

Email: [info@ultronlift.com](mailto:info@ultronlift.com)

Web: [www.ultronlift.com](http://www.ultronlift.com)

**Ultron Lift Inc.**  
**Les Hayons Ultron Inc.**  
 90 North Queen Street  
 Etobicoke, ON M8Z 2C9  
 Phone: 800.289.1335  
 Fax: 716.854.5424  
[www.ultronlift.com](http://www.ultronlift.com)

**Ultron Lift Corp.**  
 190 Lewis Street, PO Box 6126  
 Buffalo, NY 14240-6126 USA  
 Phone: 800.289.1335  
 716.853.7994  
 Fax: 716.854.5424